

**01** Key Plan  
Scope of Work

Scale 1:200m @ A1 / 1:400m @ A3

**02** Locality Plan  
Locality Plan

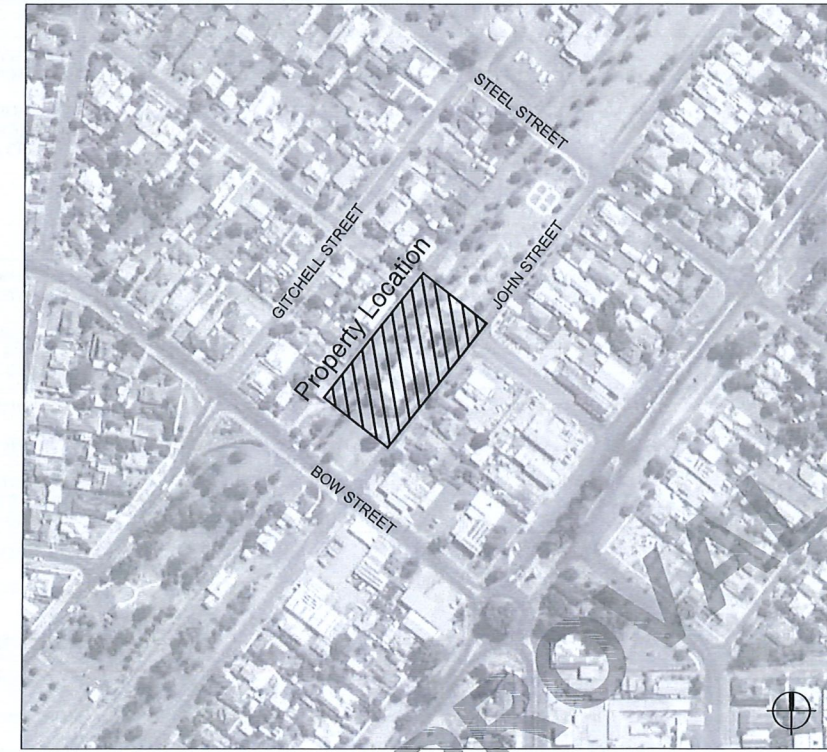

N.T.S

**SCHEDULE OF DRAWINGS**

DRAWING NO.	DRAWING TITLE
TSP - CD-001	COVER SHEET & SCHEDULE OF DRAWINGS
TSP - CD-002	SCHEDULE OF FINISHES
TSP - CD-003	SCHEDULE OF FINISHES
TSP - CD-004	TECHNICAL SKATE PARK CONSTRUCTION NOTES
TSP - CD-005	TECHNICAL SKATE PARK CONSTRUCTION NOTES
TSP - CD-006	TECHNICAL LANDSCAPE CONSTRUCTION NOTES
TSP - CD-007	EXISTING SITE CONDITIONS PLAN
TSP - CD-008	SITE CLEARANCE & TREE PROTECTION PLAN
TSP - CD-009	BULK EARTHWORKS & GRADING PLAN
TSP - CD-010	SETOUT AND MEASUREMENTS PLAN
TSP - CD-011	LEVELS AND DRAINAGE PLAN
TSP - CD-012	SURFACE FINISHES PLAN
TSP - CD-013	SKATE COPING AND STEEL SETOUT PLAN
TSP - CD-014	JOINTING LAYOUT PLAN
TSP - CD-015	COORDINATES PLAN
TSP - CD-016	FURNITURE PLAN
<b>- SECTIONS -</b>	
TSP - S100	SECTIONS KEY PLAN
TSP - S101	SECTIONS SHEET 01
TSP - S102	SECTIONS SHEET 02
TSP - S103	SECTIONS SHEET 03
<b>- DETAILS -</b>	
TSP - CD-901	SKATE PARK CONSTRUCTION DETAILS
TSP - CD-902	SKATE PARK CONSTRUCTION DETAILS
TSP - CD-903	SKATE PARK CONSTRUCTION DETAILS
TSP - CD-904	SKATE PARK CONSTRUCTION DETAILS
TSP - CD-905	SKATE PARK CONSTRUCTION DETAILS
TSP - CD-906	SKATE PARK CONSTRUCTION DETAILS
TSP - CD-907	SKATE PARK CONSTRUCTION DETAILS
TSP - CD-908	SKATE PARK SHOP DRAWINGS
TSP - CD-909	SKATE PARK SHOP DRAWINGS
TSP - CD-910	SKATE PARK SHOP DRAWINGS
TSP - CD-911	PLANTING DETAILS
TSP - CD-912	PLANTING DETAILS
TSP - CD-913	CUT-SHEET
TSP - CD-914	CUT-SHEET
TSP - CD-915	CUT-SHEET
TSP - CD-916	CUT-SHEET
TSP - CD-917	CUT-SHEET
TSP - CD-918	CUT-SHEET
TSP - CD-919	PER APPROVAL

**- CONTRACTORS WARNING -**  
BEWARE OF UNDERGROUND AND OVERHEAD SERVICES. THE LOCATIONS OF UNDERGROUND AND OVERHEAD SERVICES SHOWN IN PLANS ARE INDICATIVE ONLY.  
THE EXACT POSITION OF ALL SERVICES, BOUNDARY ALIGNMENTS AND PUBLIC LANDSCAPE INFRASTRUCTURE SHOULD BE LOCATED AND CONFIRMED ON SITE PRIOR TO THE COMMENCEMENT OF ANY WORKS. THE CONTRACTOR IS TO VERIFY ALL DIMENSIONS ON SITE BEFORE COMMENCING ANY WORK.  
ALL DISCREPANCIES ARE TO BE REPORTED TO THE DESIGNER AND THE SUPERINTENDENT PRIOR TO CONSTRUCTION.  
WRITTEN DIMENSIONS ON PLANS ARE TO BE TAKEN IN PREFERENCE TO SCALED DRAWINGS.  
THIS DRAWING AND DESIGN IS SUBJECT TO COPYRIGHT AND MAY NOT BE REPRODUCED WITHOUT WRITTEN CONSENT FROM TRINITY SKATE PARKS

Drawings Status:  
**FOR TENDER**

Note:  
The Permanent Mark (PM) to be used as a reference for this project is:  
BALROOTAN TBM  
N 4995.054  
E 59950.740  
Elevation: +98.320

Landscape Architect:



**cultivating active healthy communities.**

Structural Engineers Lighting Engineers Other Consultants  
CARDNO  
Level 1, 9 Maud Street,  
Maroochydore  
Queensland 4558  
Tel: +61 7 5409 8435  
www.carno.com

Client / Council:  
**FEDERATION COUNCIL**  
100 Edward St, Corowa NSW 2646, Australia

Project Name:  
**COROWA PARK**  
John Street, Corowa, NSW, Australia

Date	Issue	Rev.No
14-08-19	[CD] For Tender	E
24-07-19	[CD] For Engineer Revision	D
18-06-19	[CD] For Engineer Revision	C
13-06-19	[CD] For Engineer Revision	B
07-06-19	[CD] For Engineer Revision	A
-	-	-
-	-	-
-	-	-
-	-	-

Project No: TSP-CSP  
Contract Reference No: -  
Draw by: AB  
Checked by: CF

Drawing Name: COVER SHEET

Drawing Number	Revision:	North:
<b>CD-001</b>	<b>E</b>	

**IMPORTANT NOTES:**  
- WARNING TO THE CONTRACTOR -  
IT IS THE RESPONSIBILITY OF THE CONTRACTOR TO VERIFY LOCATION, DEPTH/CLEARANCE AND ALIGNMENT OF ALL OVERHEAD AND UNDERGROUND SERVICES. CONTRACTOR TO ACQUIRE UP TO DATE 'DIAL BEFORE YOU DIG/ONE CALL' SERVICES DRAWINGS AND ADHERE TO ALL REQUIREMENTS FOR WORKS NEAR SERVICES INCLUDING CLEARANCES, EASEMENTS AND INFORMING SERVICE AUTHORITIES PRIOR TO COMMENCEMENT OF ANY WORKS.  
THE UNDERGROUND SERVICES AND ASSOCIATED PITS INDICATED IN THIS SET OF DRAWINGS ARE INDICATIVE ONLY. ALL LOCATIONS SHOULD BE CONFIRMED BY A LICENSED SURVEYOR AND OR A GROUND PENETRATING RADAR SERVICE.

PARKS) FOR CLARIFICATION AND OR APPROVAL IN WRITING PRIOR TO WORKS COMMENCING / CONTINUING.

CONTRACTOR TO CROSS REFERENCE ALL PLANS TO ENSURE ALL INFORMATION MATCHES. DESIGNER (TRINITY SKATE PARKS) TO BE CONTACTED WITH ANY DISCREPANCIES OR REQUIRED CLARITY FOR APPROVAL IN WRITING PRIOR TO WORKS COMMENCING/CONTINUING.

**IMPORTANT GEOTECHNICAL NOTE:**  
CONTRACTOR TO READ AND COMPLY WITH RECOMMENDATIONS OF 'SMS' GEO-TECHNICAL REPORT "TBC".  
CONFIRM QUESTIONS OR QUERIES ONSITE WITH PROJECT MANAGER AND SUPERINTENDENT PRIOR TO COMMENCEMENT OF CONSTRUCTION.

NOTE: "COUNCIL TO SUPPLY GEO-TECHNICAL INFORMATION"

ALL EXISTING LEVELS TO BE CONFIRMED ONSITE PRIOR TO CONSTRUCTION.  
ANY DISCREPANCIES BETWEEN OR WITHIN THE DOCUMENTATION SHALL BE REPORTED IMMEDIATELY TO THE SUPERINTENDENT FIRST AND THEN TO THE DESIGNER (TRINITY SKATE



It is responsibility of the Contractor to confirm the exact location of the property boundary "On-Site" with Councils Superintendent. A qualified surveyor must be used to locate the boundary prior to the commencement of any construction works.

**CONTRACTORS WARNING -**  
BEWARE OF UNDERGROUND AND OVERHEAD SERVICES.  
THE LOCATIONS OF UNDERGROUND AND OVERHEAD SERVICES SHOWN IN PLANS ARE **INDICATIVE ONLY**.  
THE EXACT POSITION OF ALL SERVICES, BOUNDARY ALIGNMENTS AND PUBLIC LANDSCAPE INFRASTRUCTURE SHOULD BE LOCATED AND CONFIRMED ON SITE PRIOR TO THE COMMENCEMENT OF ANY WORKS. THE CONTRACTOR IS TO VERIFY ALL DIMENSIONS ON SITE BEFORE COMMENCING ANY WORK.  
ALL DISCREPANCIES ARE TO BE REPORTED TO THE DESIGNER AND THE SUPERINTENDENT PRIOR TO CONSTRUCTION.  
WRITTEN DIMENSIONS ON PLANS ARE TO BE TAKEN IN PREFERENCE TO SCALED DRAWINGS.  
THIS DRAWING AND DESIGN IS SUBJECT TO COPYRIGHT AND MAY NOT BE REPRODUCED WITHOUT WRITTEN CONSENT FROM TRINITY SKATE PARKS.

Drawings Status:

**FOR TENDER**

**GENERAL LEGEND:**

- EOW - Denote Extent Of Works on plan.
- Existing tree to be retained and protected.
- Major Contour
- TPZ Tree Protection Zone (Fenced) Refer to Specification-Refer to AS4970 (2009) TPZ for reference only, trees outside of Scope of work and temporary fence area.
- Temporary Work Area Site Fencing
- 1600 Dimensions  
All dimensions in "mm" U.N.O.
- Proposed construction Setout Origin  
- Refer to existing conditions plan for PSM  
- Setout Grid lines for new works from origin.
- Proposed skate park section symbol  
- Refer to details & section sheets  
-S101 & CD-900 series

Note:  
The Permanent Mark (PM) to be used as a reference for this project is:  
BALROOTAN TBM  
N 4995.054  
E 59950.740  
Elevation: +98.320

Landscape Architect:



**cultivating  
active  
healthy  
communities.**

Structural Engineers    Lighting Engineers    Other Consultants  
CARDNO  
Level 1, 9 Maud Street,  
Maroochydore  
Queensland 4558  
Tel: +061 7 5409 8435  
www.carno.com

Client / Council:

**FEDERATION  
COUNCIL**

100 Edward St, Corowa NSW 2646, Australia

Project Name:

**COROWA PARK**

John Street, Corowa, NSW, Australia

Date	Issue	Rev.No
14-08-19	[CD] For Tender	E
24-07-19	[CD] For Engineer Revision	D
18-06-19	[CD] For Engineer Revision	C
13-06-19	[CD] For Engineer Revision	B
07-06-19	[CD] For Engineer Revision	A
-	-	-
-	-	-

Project No: TSP-CSP  
Contract: Reference No: -  
Draw by: AB  
Checked by: CF

Drawing Name: SECTIONS KEY PLAN

Drawing Number	Revision:	North:
S-100	E	⊕

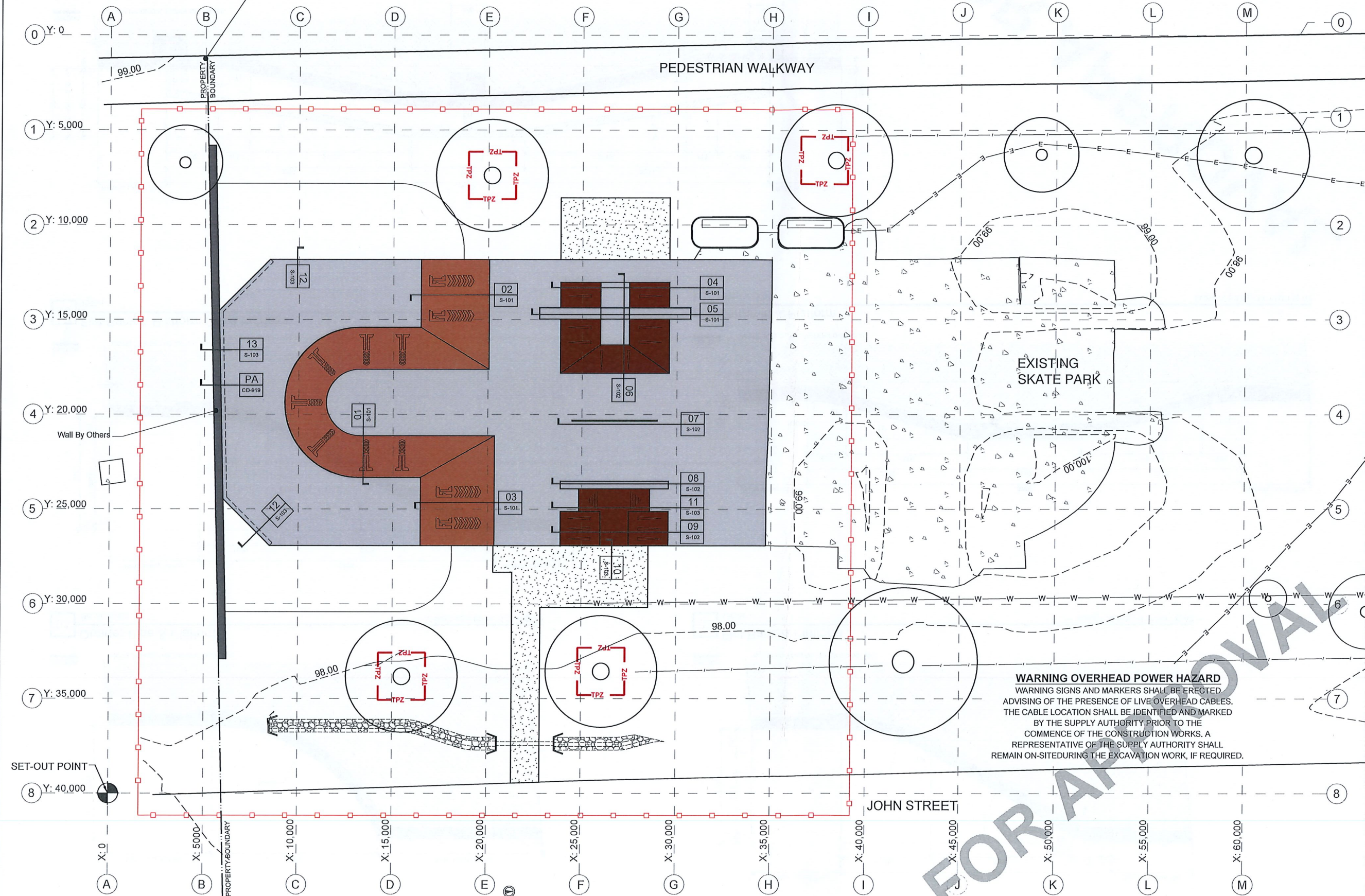

**WARNING OVERHEAD POWER HAZARD**  
WARNING SIGNS AND MARKERS SHALL BE ERECTED ADVISING OF THE PRESENCE OF LIVE OVERHEAD CABLES. THE CABLE LOCATION SHALL BE IDENTIFIED AND MARKED BY THE SUPPLY AUTHORITY PRIOR TO THE COMMENCEMENT OF THE CONSTRUCTION WORKS. A REPRESENTATIVE OF THE SUPPLY AUTHORITY SHALL REMAIN ON-SITE DURING THE EXCAVATION WORK, IF REQUIRED.

**01** Sections Key Plan  
Plan

Scale 1:100m @ A1 / 1:200m @ A3



**\* CONTRACTORS WARNING \***  
 BEWARE OF UNDERGROUND AND OVERHEAD SERVICES.  
 THE LOCATIONS OF UNDERGROUND AND OVERHEAD SERVICES SHOWN IN PLANS ARE **INDICATIVE ONLY**.  
 THE EXACT POSITION OF ALL SERVICES, BOUNDARY ADJUSTMENTS AND PUBLIC LANDSCAPE INFRASTRUCTURE SHOULD BE LOCATED AND CONFIRMED ON SITE PRIOR TO THE COMMENCEMENT OF ANY WORKS. THE CONTRACTOR IS TO VERIFY ALL DIMENSIONS ON SITE BEFORE COMMENCING ANY WORK.  
 ALL DISCREPANCIES ARE TO BE REPORTED TO THE DESIGNER AND THE SUPERINTENDENT PRIOR TO CONSTRUCTION.  
 WRITTEN DIMENSIONS ON PLANS ARE TO BE TAKEN IN PREFERENCE TO SCALED DRAWINGS.  
 THIS DRAWING AND DESIGN IS SUBJECT TO COPYRIGHT AND MAY NOT BE REPRODUCED WITHOUT WRITTEN CONSENT FROM TRINITY SKATEPARKS.

Drawings Status:

**FOR TENDER**

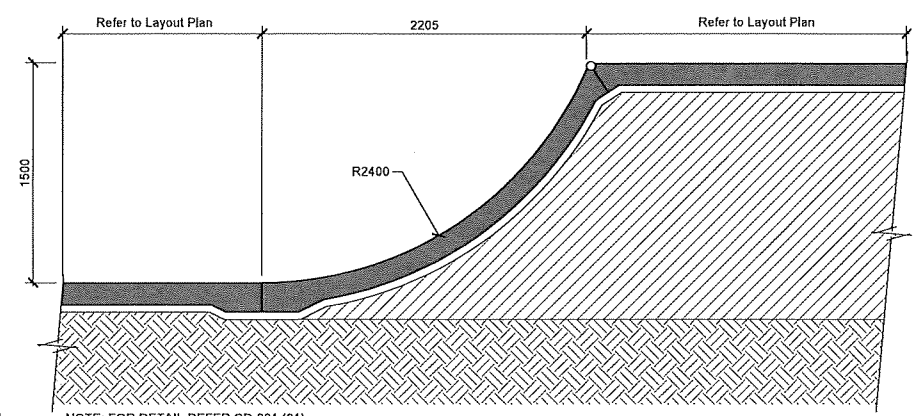

**01** Quarter Pipe & Platform  
 1500H/R2400 Scale 1:25m @ A1 / 1:50m @ A3

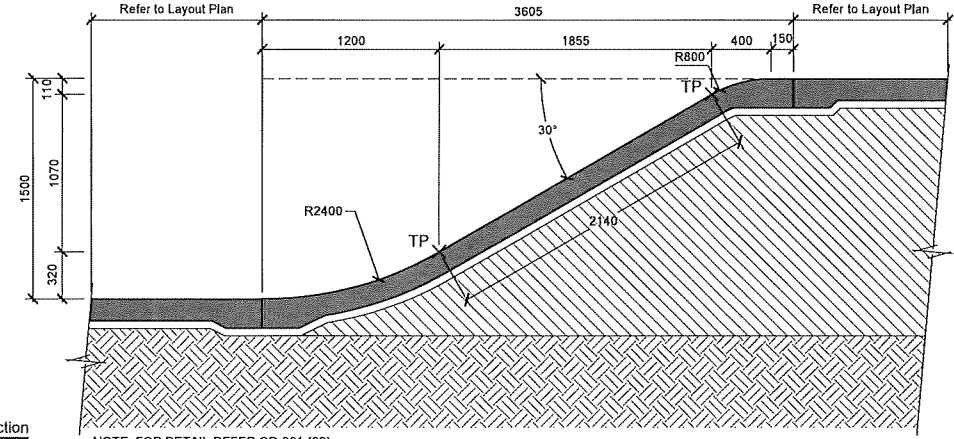

**02** Flat Bank & Platform  
 1500H Scale 1:25m @ A1 / 1:50m @ A3

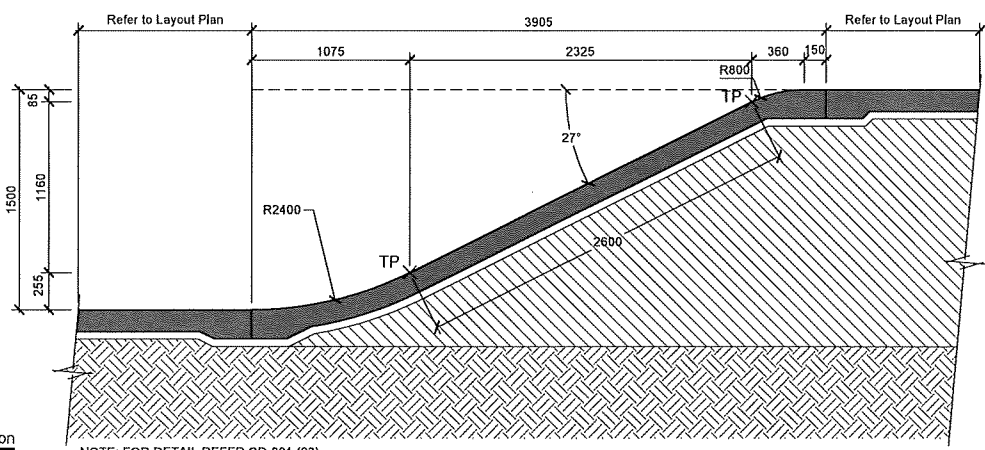

**03** Flat Bank & Platform (Next to Stairs)  
 1500H Scale 1:25m @ A1 / 1:50m @ A3

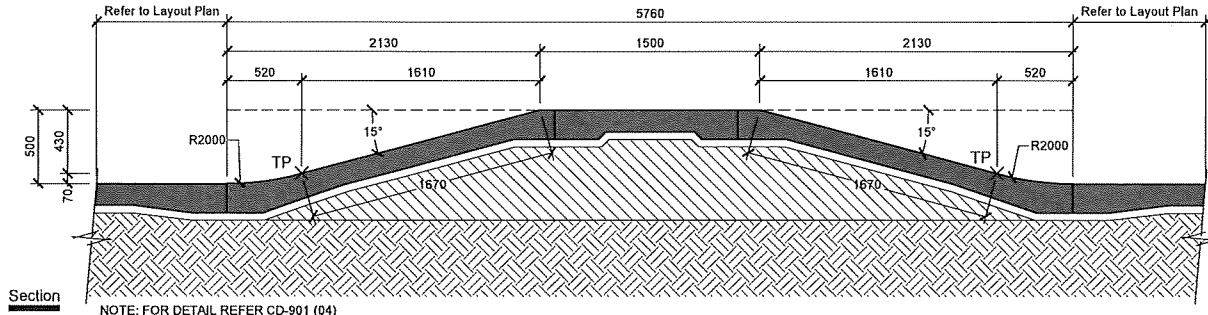

**04** Pyramid & Platform  
 500H/R2000 Scale 1:25m @ A1 / 1:50m @ A3

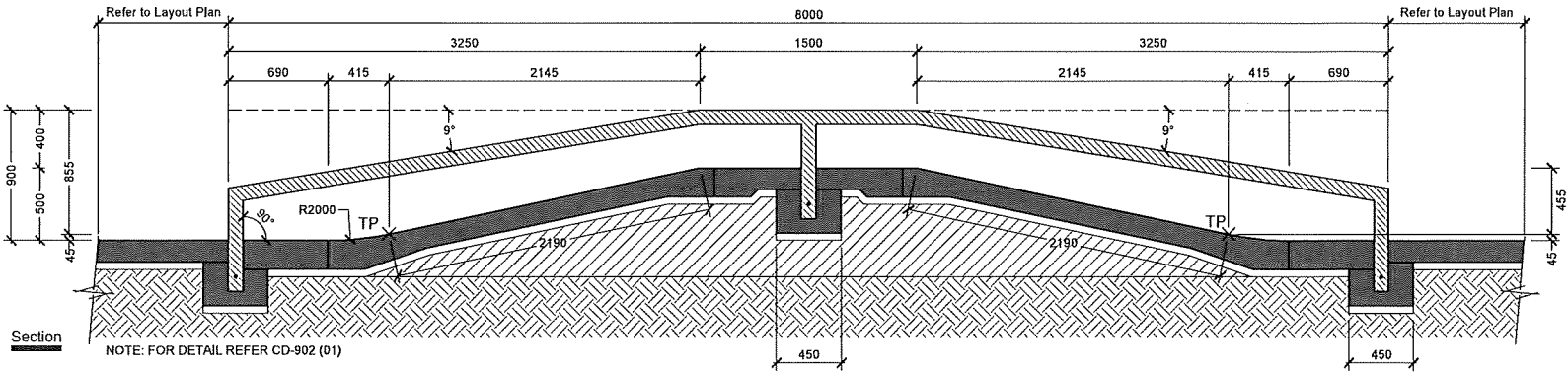

**05** Pyramid Ledge  
 900H Scale 1:25m @ A1 / 1:50m @ A3

Landscape Architect:  
 **cultivating active healthy communities.**  
 Structural Engineers Lighting Engineers Other Consultants  
 CARDNO  
 Level 1, 9 Maud Street,  
 Manlybyrdie  
 Queensland 4558  
 Tel: +061 7 5409 8435  
 www.cane.com

Client / Council:  
**FEDERATION COUNCIL**  
 100 Edward St, Corowa NSW 2646, Australia

Project Name:  
**COROWA PARK**  
 John Street, Corowa, NSW, Australia

Date	Issue	Rev.No
14-08-19	[CD] For Tender	E
24-07-19	[CD] For Engineer Revision	D
18-05-19	[CD] For Engineer Revision	C
13-05-19	[CD] For Engineer Revision	B
07-06-19	[CD] For Engineer Revision	A
-	-	-
-	-	-
-	-	-

Project No: TSP-CSP  
 Contract Reference No: -  
 Draw by: AB  
 Checked by: CF

Drawing Name: SECTION SHEET 01

Drawing Number	Revision:
<b>S101</b>	<b>E</b>

FOR APPROVAL

**CONTRACTORS WARNING -**  
 BEWARE OF UNDERGROUND AND OVERHEAD SERVICES.  
 THE LOCATIONS OF UNDERGROUND AND OVERHEAD SERVICES SHOWN IN PLANS ARE INDICATIVE ONLY.  
 THE EXACT POSITION OF ALL SERVICES, BOUNDARY ALIGNMENTS AND PUBLIC LANDSCAPE INFRASTRUCTURE SHOULD BE LOCATED AND CONFIRMED ON SITE PRIOR TO THE COMMENCEMENT OF ANY WORK. THE CONTRACTOR IS TO VERIFY ALL DIMENSIONS ON SITE BEFORE COMMENCING ANY WORK.  
 ALL DISCREPANCIES ARE TO BE REPORTED TO THE DESIGNER AND THE SUPERINTENDENT PRIOR TO CONSTRUCTION.  
 WRITTEN DIMENSIONS ON PLANS ARE TO BE TAKEN IN PREFERENCE TO SCALED DRAWINGS.  
 THIS DRAWING AND DESIGN IS SUBJECT TO COPYRIGHT AND MAY NOT BE REPRODUCED WITHOUT WRITTEN CONSENT FROM TRINITY SKATE PARKS

Drawings Status:

**FOR TENDER**

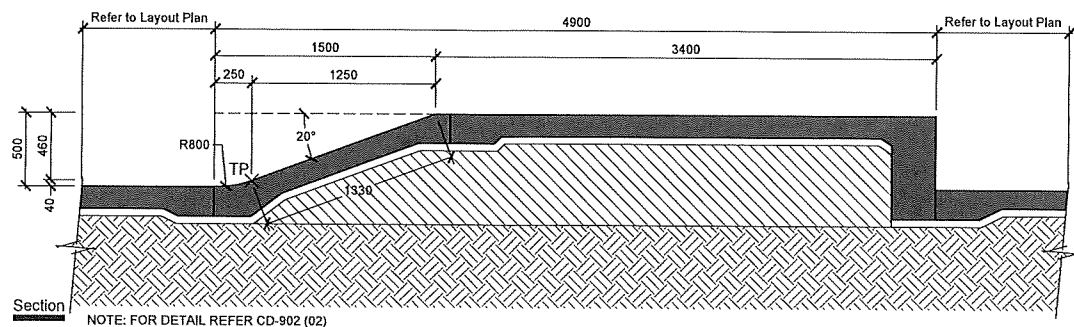

**06 Ramp & Platform w/ Turn down wall**

500H/R800

Scale 1:25m @ A1 / 1:50m @ A3

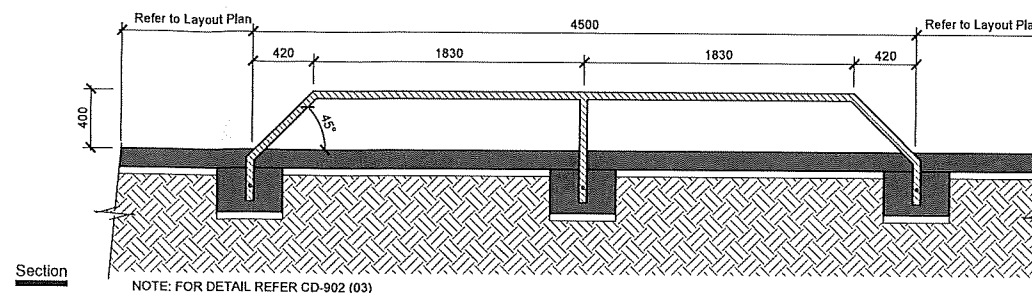

**07 Pyramid Rail**

900H

Scale 1:25m @ A1 / 1:50m @ A3

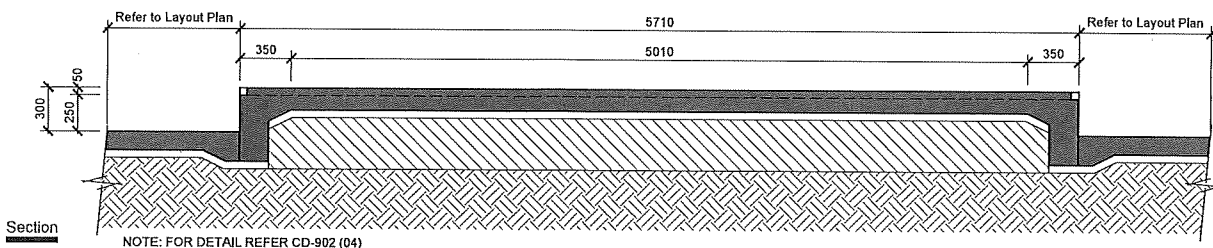

**08 Flat Ledge**

200H

Scale 1:25m @ A1 / 1:50m @ A3

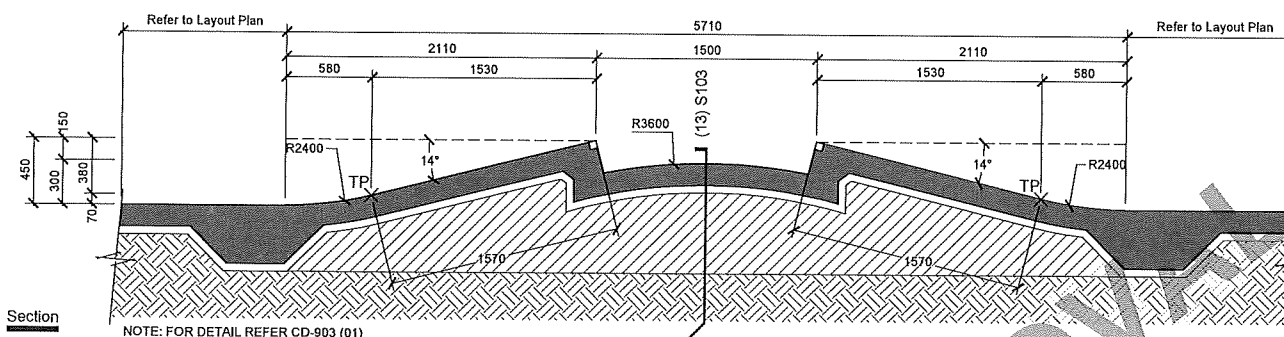

**09 Kicker to Kicker**

450H/R2400-3600

Scale 1:25m @ A1 / 1:50m @ A3

Landscape Architect:



**cultivating  
active  
healthy  
communities.**

Structural Engineers Lighting Engineers Other Consultants

CARDNO  
 Level 1, 9 Maud Street,  
 Maroochydore  
 Queensland 4558  
 Tel: +061 7 5409 8435  
 www.carno.com

Client / Council:

**FEDERATION  
COUNCIL**

100 Edward St, Corowa NSW 2646, Australia

Project Name:

**COROWA PARK**

John Street, Corowa, NSW, Australia

Date	Issue	Rev.No
14-08-19	[CD] For Tender	E
24-07-19	[CD] For Engineer Revision	D
18-06-19	[CD] For Engineer Revision	C
13-05-19	[CD] For Engineer Revision	B
07-06-19	[CD] For Engineer Revision	A
-	-	-
-	-	-
-	-	-

Project No: TSP-CSP  
 Contract Reference No: -  
 Draw by: AB  
 Checked by: CF

Drawing Name: SECTION SHEET 02

Drawing Number	Revision:
<b>S102</b>	<b>E</b>

**FOR APPROVAL**

CONTRACTOR'S WARNING - BEWARE OF UNDERGROUND AND OVERHEAD SERVICES. THE LOCATIONS OF UNDERGROUND AND OVERHEAD SERVICES SHOWN IN PLANS ARE INDICATIVE ONLY.

THE EXACT POSITION OF ALL SERVICES, BOUNDARY ALIGNMENTS AND PUBLIC LANDSCAPE INFRASTRUCTURE SHOULD BE LOCATED AND CONFIRMED ON SITE PRIOR TO THE COMMENCEMENT OF ANY WORKS. THE CONTRACTOR IS TO VERIFY ALL DIMENSIONS ON SITE BEFORE COMMENCING ANY WORK.

ALL DISCREPANCIES ARE TO BE REPORTED TO THE DESIGNER AND THE SUPERINTENDENT PRIOR TO CONSTRUCTION. WRITTEN DIMENSIONS ON PLANS ARE TO BE TAKEN IN PREFERENCE TO SCALED DRAWINGS.

THIS DRAWING AND DESIGN IS SUBJECT TO COPYRIGHT AND MAY NOT BE REPRODUCED WITHOUT WRITTEN CONSENT FROM TRINITY SKATEPARKS

Drawings Status:

FOR TENDER

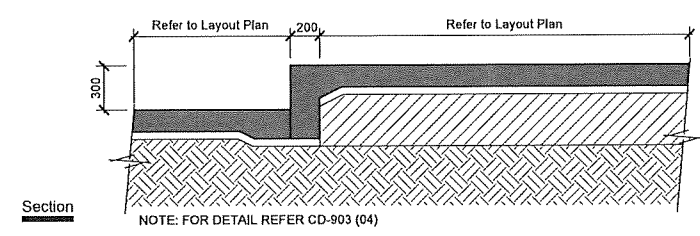

Section  
**10** Roll Over / Kicker to Kicker (Transverse View)  
 300H Scale 1:25m @ A1 / 1:50m @ A3

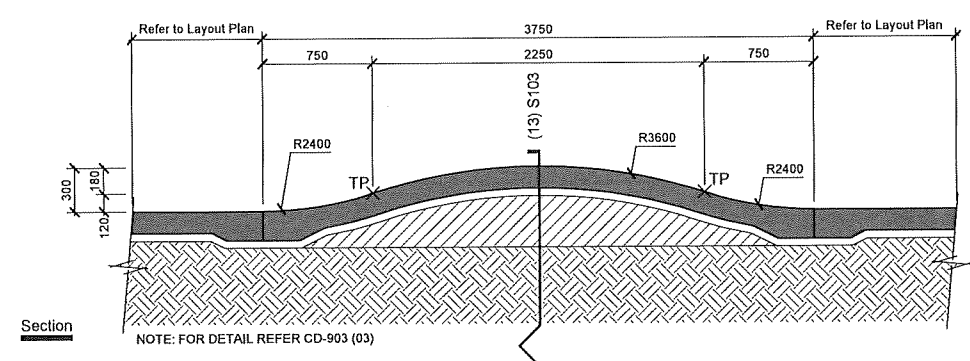

Section  
**11** Roll-Over  
 300H/R2400-3600 Scale 1:25m @ A1 / 1:50m @ A3

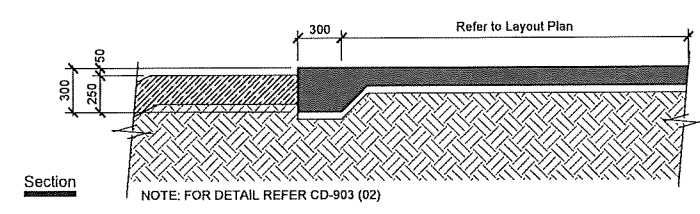

Section  
**12** 300 Step-Down Infill Wall  
 300H Scale 1:25m @ A1 / 1:50m @ A3

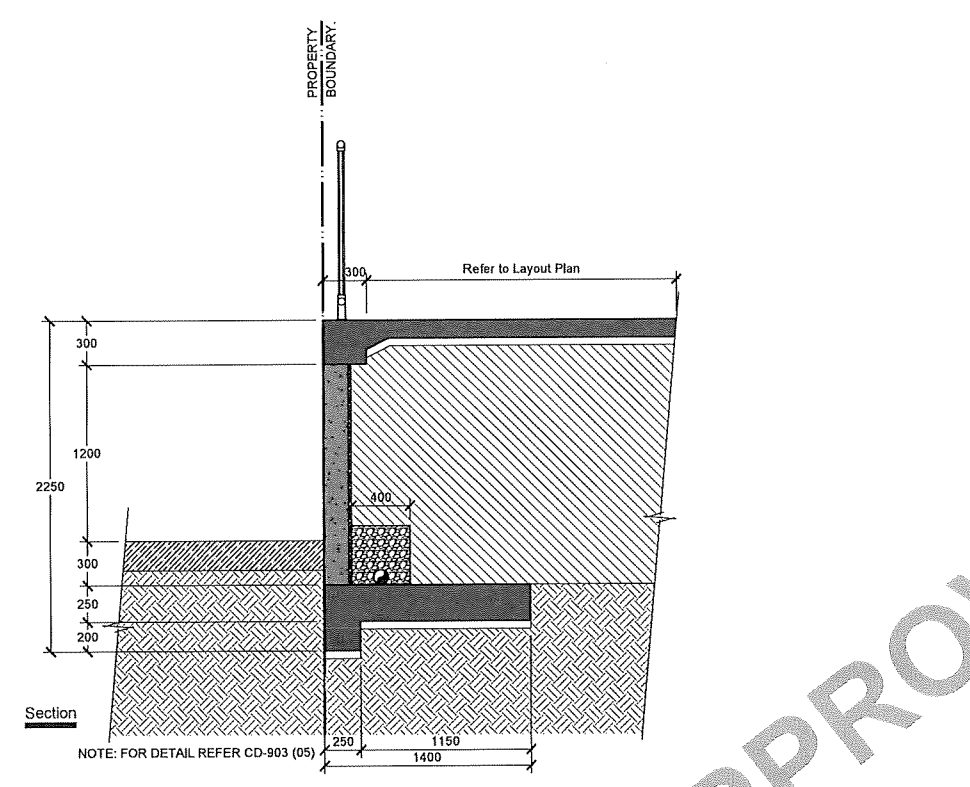

Section  
**13** 300 Step-Down Infill Wal / Retaining Wall and Drain - Option #1  
 300H Scale 1:25m @ A1 / 1:50m @ A3

Landscape Architect:



**cultivating active healthy communities.**

Structural Engineers Lighting Engineers Other Consultants

CARDNO  
 Level 1, 9 Nass Street,  
 Maroochydore  
 Queensland 4558  
 Tel: +061 7 5409 8435  
 www.came.com

Client / Council:

**FEDERATION COUNCIL**

100 Edward St, Corowa NSW 2646, Australia

Project Name:

**COROWA PARK**

John Street, Corowa, NSW, Australia

Date	Issue	Rev.No
14-08-19	[CD] For Tender	E
24-07-19	[CD] For Engineer Revision	D
18-06-19	[CD] For Engineer Revision	C
13-06-19	[CD] For Engineer Revision	B
07-06-19	[CD] For Engineer Revision	A
-	-	-
-	-	-
-	-	-

Project No: TSP-CSP  
 Contract Reference No: -  
 Draw by: AB  
 Checked by: CF

Drawing Name: SECTION SHEET 03

Drawing Number	Revision:
<b>S103</b>	<b>E</b>

FOR APPROVAL