



Federation Council Standard Drawing Index

Series 300 - Pedestrian Access

SD 300 - Standard Pram Crossing

SD 301 - Concrete Footpaths

SD 302 - Asphalt Footpaths - Typical Sections

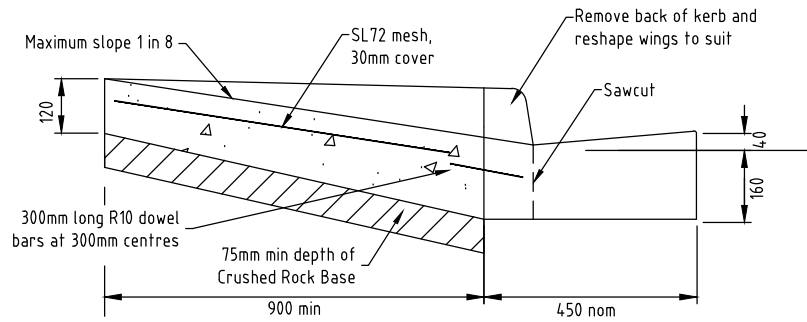

Joining onto existing kerb
Section A-A
NOT TO SCALE

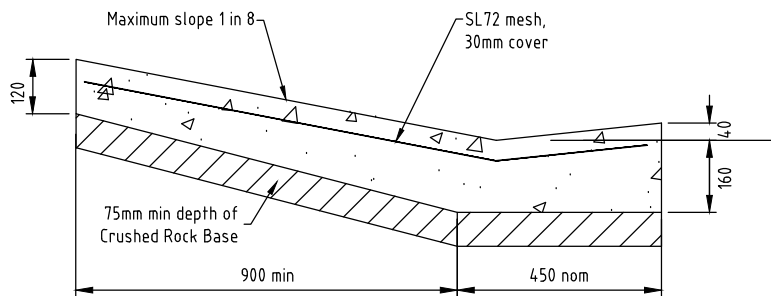

New Pram Ramp
Section A-A
NOT TO SCALE

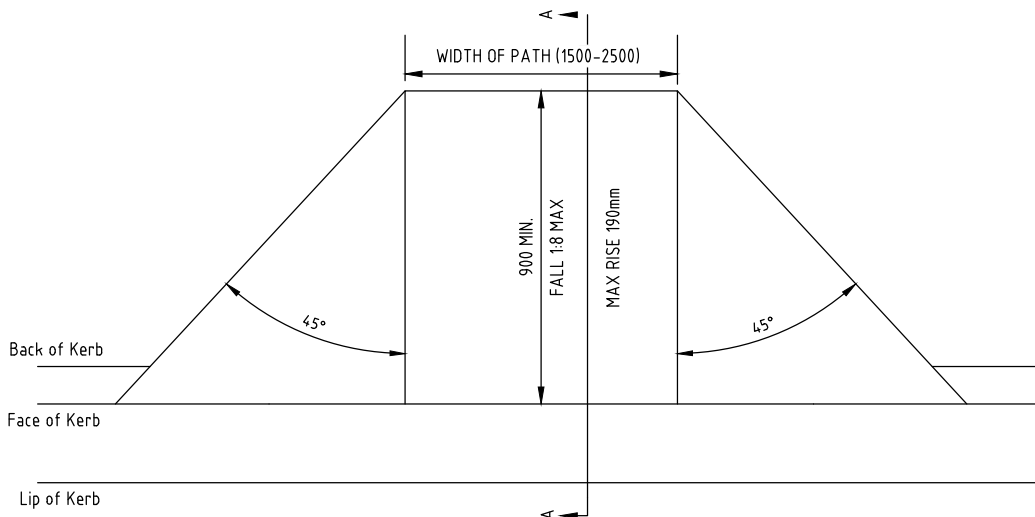

Plan
NOT TO SCALE

NOTES:

1. All measurements in millimetres.
2. Tactile ground surface indicators to be installed as per AS 1428.4.1.
3. All concrete to be 25MPa.

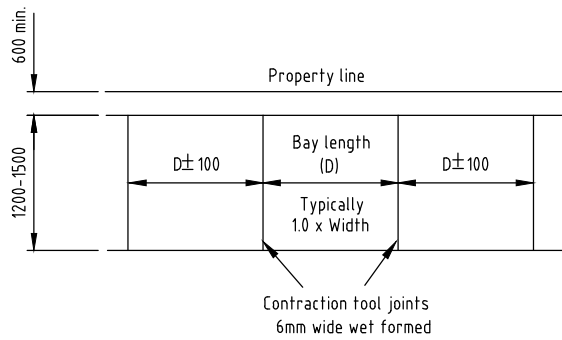

Footpath Typical Layout

All Volumes - 1500 Width

Cross fall
0.5% Min

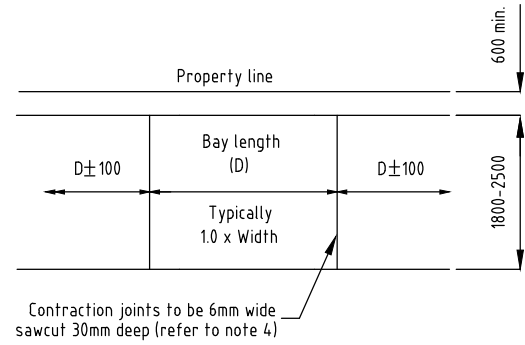

Shared Path Typical Layout

High Volume - 2500 Width
Low Volume - 1800 Width

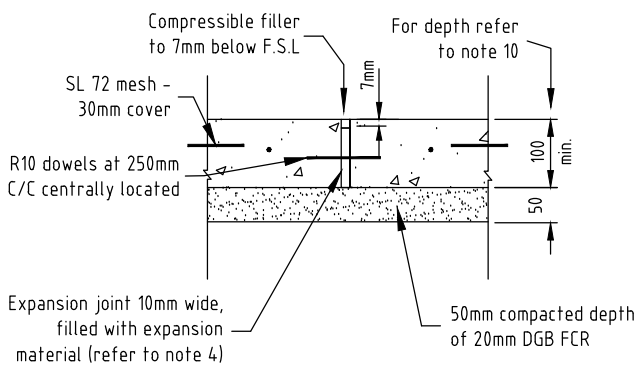

Expansion Joint Detail

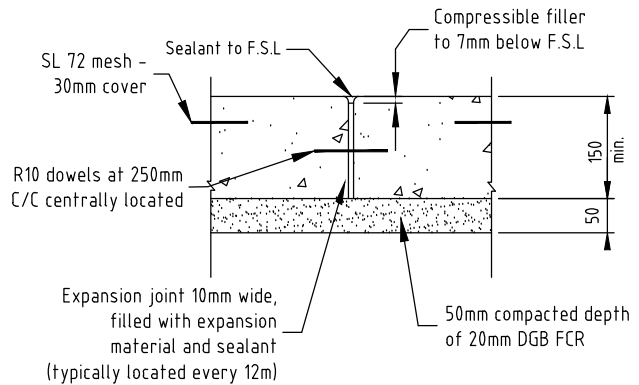

Shared Path Typical Elevation

NOTES:

1. Footpath bay length (D) shall be 1.0 times the width of the path; successive bay lengths cannot vary by more than 100mm.
2. Footpath locality to be in accordance with Councils long term plans.
3. Concrete strength (f'c) is to be 25MPa for all paths.
4. Expansion joints shall be placed at regular intervals not exceeding 12m for footpath and every 10m for shared paths.
5. All joints to be straight and of high standard.
6. In order to improve rider comfort, grooving tools are not to be used on shared paths.
7. Crossfall to be a minimum of 0.5% and a maximum of 4% with 2% being ideal.
8. Grades to be in accordance with AS 1428.1 design for access and mobility. Deviation from this standard requires Council approval.
9. Footpaths to be back filled with minimum delay to prevent undermining & improve public safety.
10. Nature strips and disturbed areas are to be surfaced with 75mm depth of approved topsoil and grass seed.
11. The depth of footpaths shall increase from 100mm to 150mm and 2 layers of SL 72 mesh laid in council reserves and open areas where heavy vehicle traffic is expected.
12. Sawcut contraction joints to be cut within 24 hours of pouring.
13. All mesh is to be chaired.
14. Surface to be broomed finished.

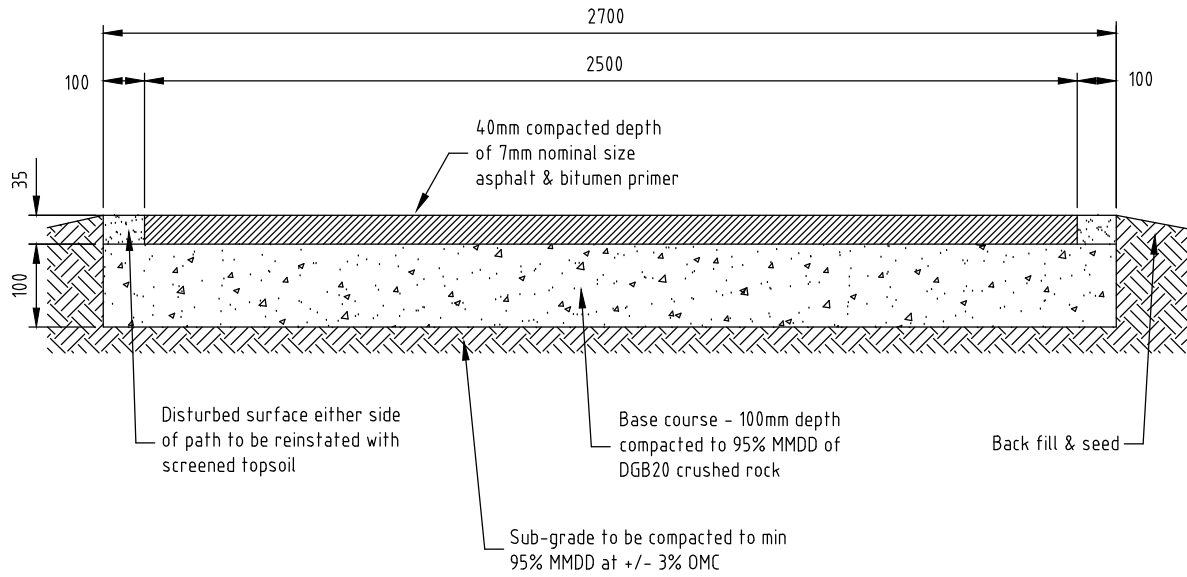

Typical Asphalt Shared Footway Elevation

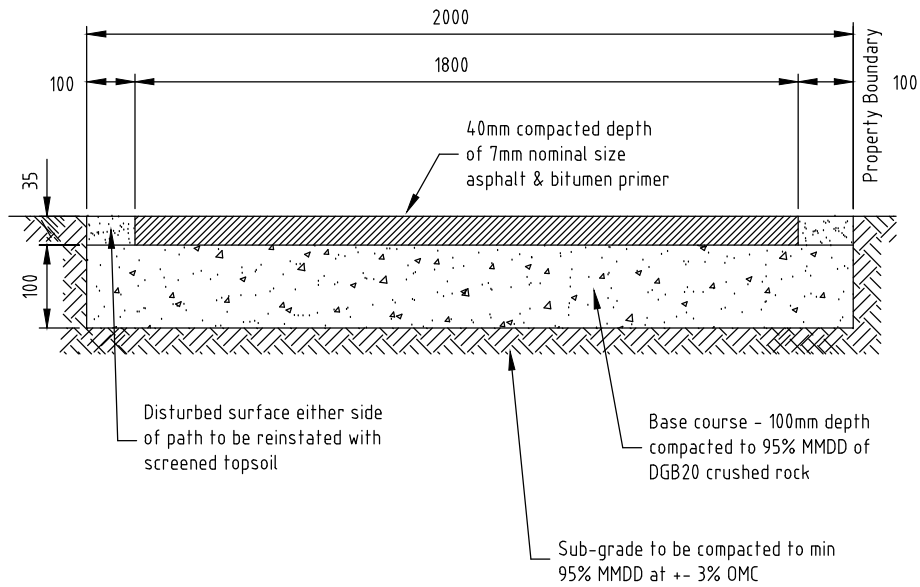

Typical Asphalt Footpath Elevation