



Federation Council Standard Drawing Index

Series 900 - Miscellaneous

SD 900 - Advanced Tree Planting - for use in Grassed or Mulched Areas

SD 901 - Speed Hump Profile - Local Area Traffic Management

SD 902 - Lock Socket Spike & Wedge - for Sign Posts

SD 903 - Street Name Sign Post

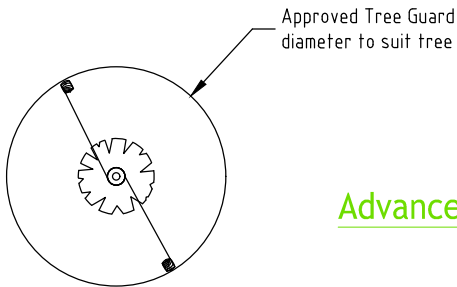
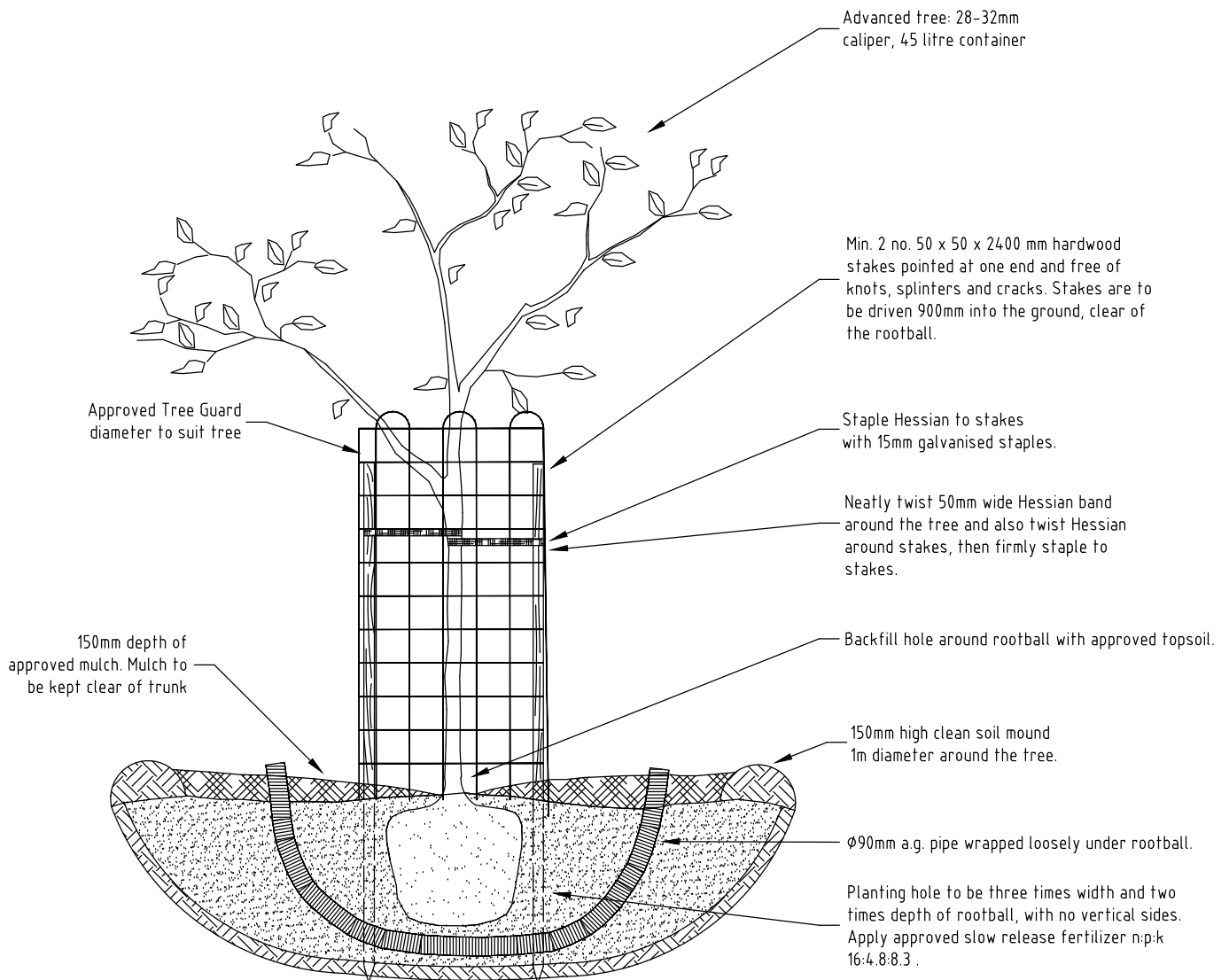

Advanced Tree Planting Detail
Not to scale

PLAN



Standard Drawing

LAST UPDATED: 11/12/18
 FILE PATH: N:_Design Manual\Federation Council Standard Drawings & Development Guidelines\Standard Drawings\900 SERIES - MISCELLANEOUS\900 SERIES.dwg

ADVANCED TREE PLANTING
FOR USE IN GRASSED OR MULCHED AREAS

SD900

REV
A

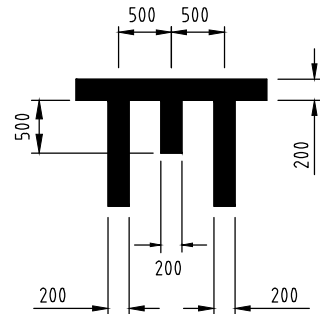
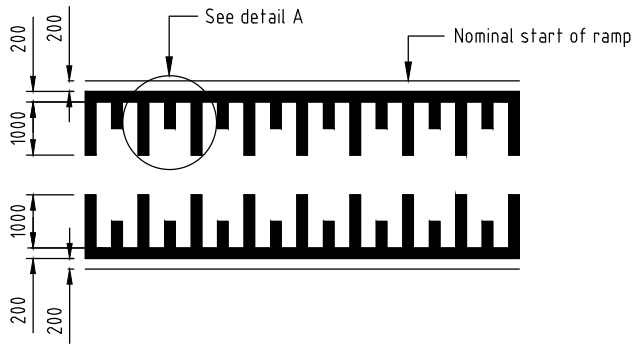

Detail A

Road Hump Linemarking

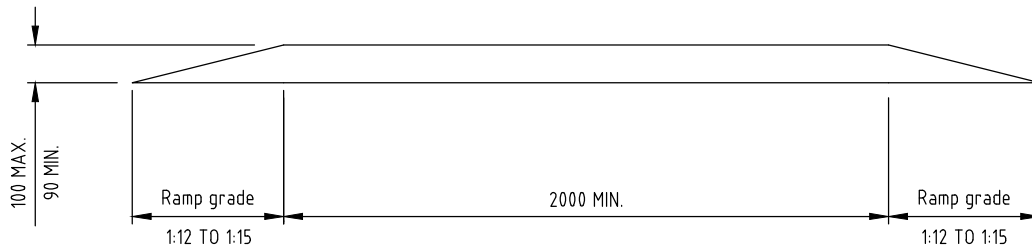

Flat Top Hump Profile
Provide bypass for cyclists where possible

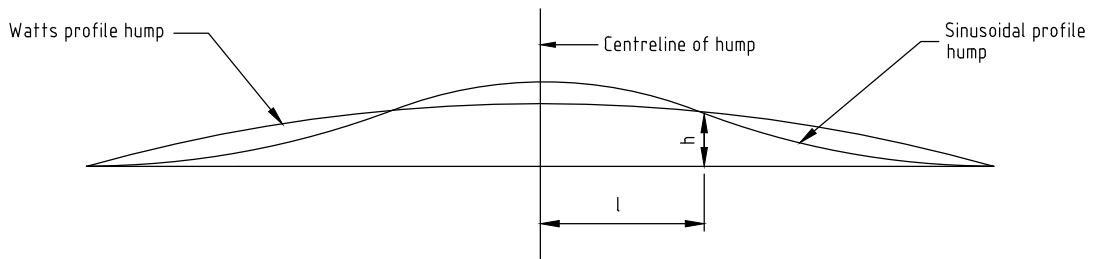

Watts Profile and Sinusoidal Profile

l (m)	0	0.1	0.2	0.3	0.4	0.5	0.6	0.7	0.8	0.9	1.0	1.1	1.2	1.3	1.4	1.5	1.6	1.7	1.8
h (mm)	100	100	99	97	95	93	90	86	81	76	71	65	58	51	43	34	25	16	5

Watts Profile Hump

NOTES:

- At ramps at entry points to shared zones, ramp grade shall be increased to between 1:2 & 1:4
- Long life paint is to be used for line marking with glass beads.

l (m)	0	0.2	0.4	0.6	0.8	1.0	1.2	1.4	1.5	1.6
h (mm)	120	116	104	87	66	44	24	9	1	0

Sinusoidal Profile Hump

Hump profiles derived from RMS 'Road Design Guide'



Standard Drawing

LAST UPDATED: 11/12/18

FILE PATH: A4
N:_Design Manual\Federation Council Standard Drawings & Development Guidelines\Standard Drawings\900 SERIES - MISCELLANEOUS\900 SERIES.dwg

SPEED HUMP PROFILE
LOCAL AREA TRAFFIC MANAGEMENT

SD901

REV
A

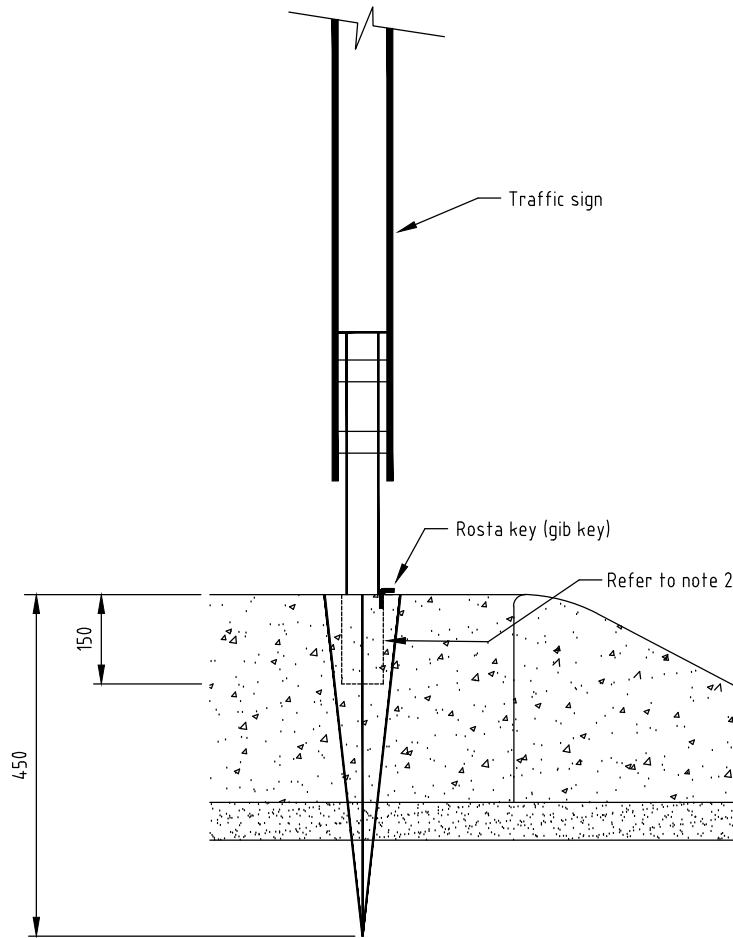

NOTES:

1. Signs are to be installed in accordance with AS1742.
2. Sleeve is to be connected into the traffic island.



Standard Drawing

LAST UPDATED: 11/12/18

FILE PATH: A4
 N:_Design Manual\Federation Council Standard Drawings & Development Guidelines\Standard Drawings\900 SERIES - MISCELLANEOUS\900 SERIES.dwg

LOCK SOCKET SPIKE & WEDGE
 FOR SIGN POSTS

SD902

REV
 A

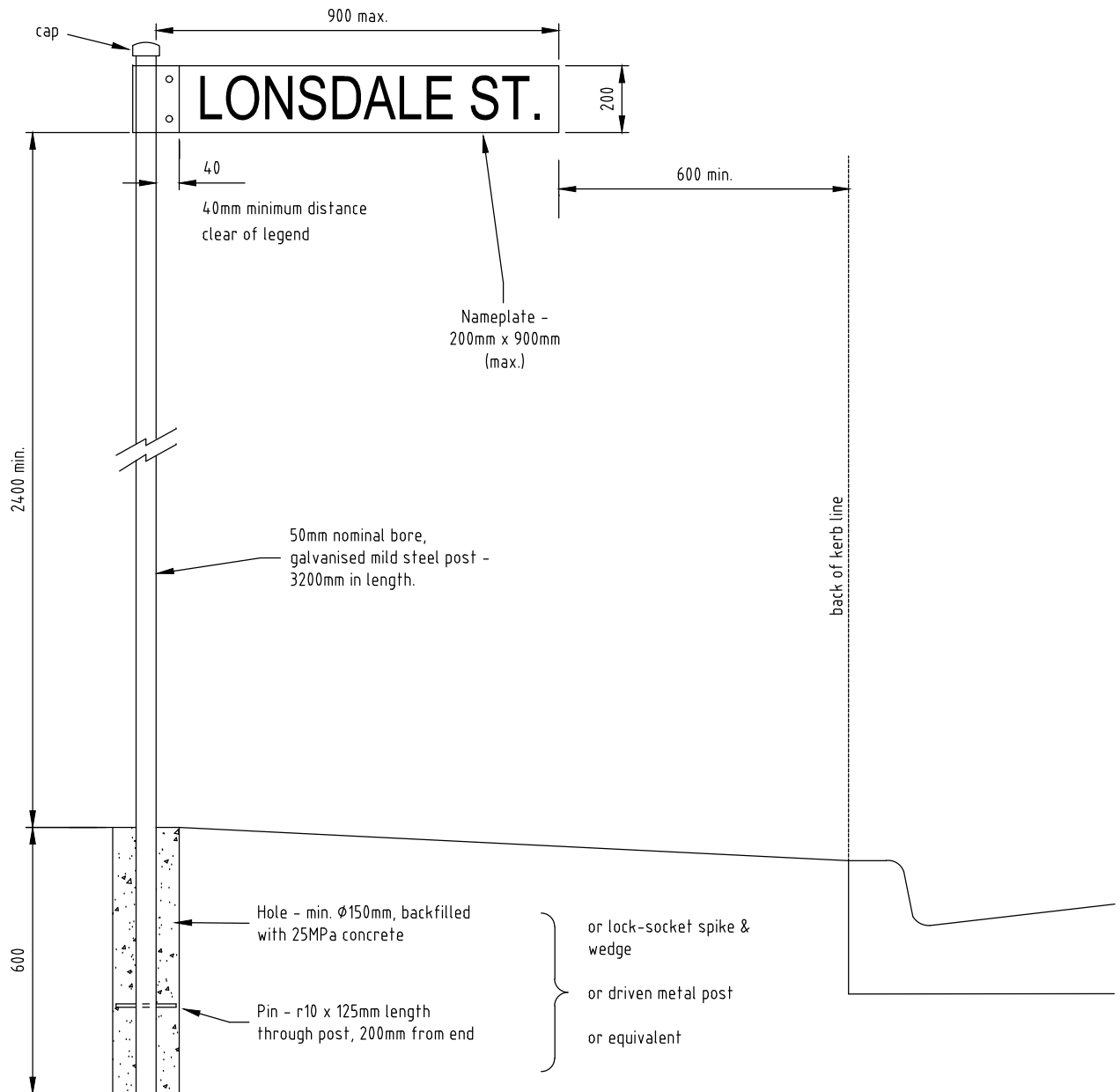

NOTES:

1. Base material - extruded aluminium blade, g5 or equivalent (150mm high x maximum length of sign - 900mm).
2. The legend shall be 100mm high with 'class c' lettering (AS 1744), unless the maximum length of the sign would be exceeded. In such cases, the lettering shall then be 'class b' (AS1744).
3. A clear distance of 40mm shall be left free of the legend on both sides of the sign at one and the same end.
4. The legend shall be class '1' high intensity black.
5. The background shall be diamond grade ldp reflective white.
6. The sign shall be attached to the pole using al16 brackets or equivalent. The use of brackets which grip the sign only at the top and bottom will not be permitted.
7. The signs will not be installed on kerb returns unless directed by the council engineer.
8. Signs to be located in accordance with AS1742.5.